

---

*PERSHING 70*



*STAND OUT*

AMAS

# PERSHING 70



OPTIONAL

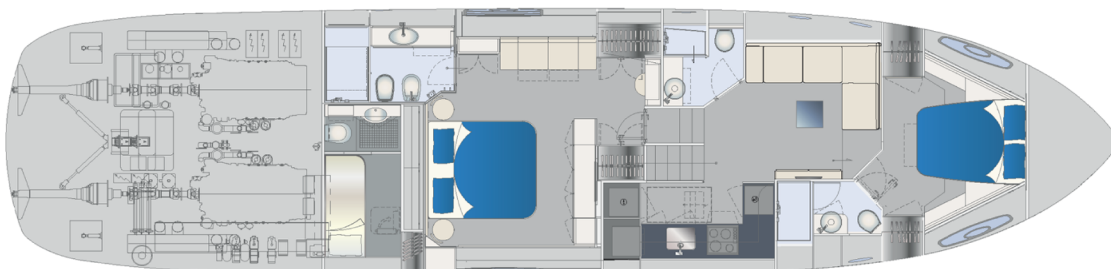
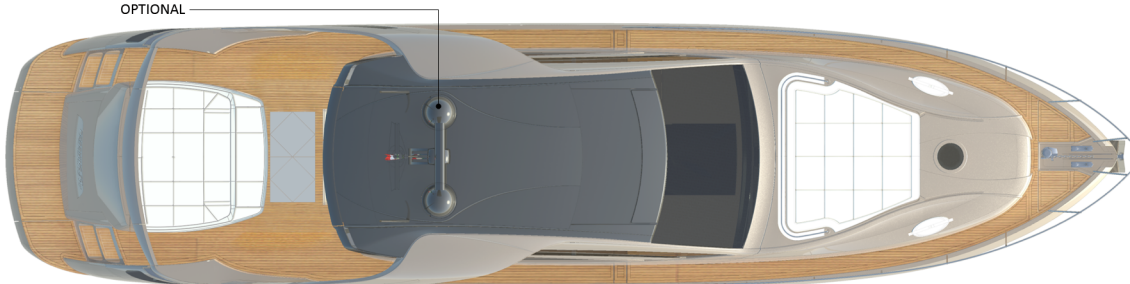

**HULL, PROPULSION AND TECHNICAL PROJECT:** FERRETTIGROUP ENGINEERING DEPARTMENT  
**YACHT DESIGNER:** FULVIO DE SIMONI

**EN TECHNICAL CHARACTERISTICS**

**ENGINES**

2 x MTU 10V 2000 M96L Power 1623 mhp/1193 kW at 2450 rpm - TS 85P

**HULL TYPE**

17° deadrise Monohedron hull with spray rails

LOA = Overall Length standard ISO 8666 .....	70ft. 4in.
LH = Hull length standard ISO 8666 .....	68ft. 3in.
LWL = Waterline length (boat fully laden) .....	56ft. 3in.
Maximum beam .....	16ft. 5in.
Overall height from keel to top roof .....	20ft. 10in.
Ht = Minimum transport height from keel .....	19ft. 0in.
Displacement unladen .....	84768 lbs.
Displacement laden .....	99583 lbs.
Depth under propellers (boat fully laden) .....	4ft. 5in. <sup>[4]</sup>
P1 = transom .....	2ft. 1in.
Fuel tank capacity .....	925 US Gals.
Water tanks capacity .....	238 US Gals.
Maximum number of people on board .....	16
Light displacement maximum speed = 1/3 laden .....	(MTU 1623) 46 knots <sup>[2]</sup>
Nr. Cabins .....	3
Nr. Bathrooms .....	3
Nr. Crew Cabins .....	1
Nr. Crew Bathrooms .....	1
Safety equipment .....	8 <sup>[3]</sup>
Design category .....	A (2013/53/EU)
Certification documents .....	B+F+Aa (Sound Emission)
.....	RINA S.p.a.

STANDARD ISO 8666 

**HULL/DECK CONSTRUCTION MATERIAL**

Hull: construction from female mould with sandwich bottom with balsa wood core and sandwich sides with closed cell PVC core; reinforcement fibers: E glass. Stratification of longitudinal stiffeners with polyurethane foam; stratification of transversal stringers with PVC core at bow, with polyurethane foam at stern.

Deck and superstructure: construction from female mould with vacuum infusion lamination with vinylester resin in closed cell PVC core sandwich format.

Main bulkheads and interior structural floors in sandwich format and vacuum infusion lamination.

Structural tanks for fuel, fresh water, grey and black water, are layered with vinylester resin.

Areas of the deck are covered in teak sealed with polymerized black rubber caulking.

STANDARD FURNITURE WOOD: Ash preformed wood

**PAINTING**

Keel painting: upon request.

External painting: white gelcoat\*; areas above the water line that are painted in a different color according to the standard Pershing shipyard graphics are treated with a bi-component polyurethane paint in black color.

\*Antifouling paint (Opt) can be applied upon request in order to guarantee more efficient antifouling properties.

<sup>[1]</sup> This technical specification is valid and refers to yacht ordered as of 1 September 2019.

<sup>[2]</sup> Performances are approximate and they refer to the standard equipment of the boat, at 1/3 of load corresponding to ton. 40,33 [88912 lb], performances estimated at the following conditions: calm sea, absence of wind, 25°C air temperature, clean hull and special propellers set for those conditions and 6 people on board. Overloading the yacht by 0,5 ton / 1102 lb top speed decreases of 1 knot.

<sup>[3]</sup> Pershing shipyard does not supply complete safety equipment as Pershing yachts are delivered to all countries, owners must therefore complete the safety equipment with the devices required in their own specific country. Pershing can, however, supply safety equipment upon request.

<sup>[4]</sup> The stated draft is with the surface drives in the zero position.

# PERSHING 70

## STANDARD EQUIPMENT

### ◆ ANTENNAS AREA

- Dome
- GPS antenna
- Horn
- Navigation lights for Italian Flag
- Signal mast in stainless steel
- Stainless steel signal/flag mast
- VHF antenna (2)

### ◆ MAIN DECK

#### COCKPIT/OUTSIDE AFT

##### DINETTE

- Cockpit cabinet in fiberglass with sink and fresh water
- Cockpit chairs (4)
- GRP table with electric movement (2)
- Hideaway sliding hard top portion
- Teak cockpit flooring
- Waterproof speakers with independent volume control (2)

#### ACCESS TO CREW CABIN

- Fiberglass door with handle and lock
- Stainless steel and teak ladder

#### ACCESS TO ENGINE

##### ROOM

- Access to engine room through hatch and locker
- Access to engine room through inox and teak ladder

#### AFT SUNBATHING AREA

- Aft mooring storages for access to the garage
- Handrails in fiberglass
- Locker port-stb
- Sunpad with seat upholstered in white vinyl fabric

#### AFT MOORING STATION

- Capstan 1500W with foot control
- Fairlead in stainless steel with rolls (2)
- Stainless steel mooring cleat (2)

#### AFT GARAGE

- Fresh water inlet from water tank
- GRP hatch
- Kit hydraulically powered tailgate
- Led spotlight (2)

#### ACCESS TO BATHING

##### PLATFORM

- Aft platform with electro-hydraulic lifting system
- Aft steps and platform covered in teak
- Courtesy lights for steps
- External shower with mixer

- Fiberglass and stainless steel gate (port/stb)
- Shore plug 100A
- Shore water inlet
- Swim ladder, hydraulic, hideaway with alarm
- Telescopic hydraulic hideaway gangway with (2) remote controls

#### SIDE WALKWAYS

- Black water pump out cap
- Fiberglass Handrail
- Fresh water filling cap
- Fuel filling cap starboard side
- Side Pershing Logo in silicon (2)
- Stainless steel mooring cleat at midship (2)
- Stainless steel railing with hooking points
- Wood covered

#### BOW SUNPAD

- Upholstery in white vinyl

#### BOW MOORING STATION

- Access to bow locker with hatch and closure (2)
- Basket chain
- Bow anchor fitting
- Courtesy LED lights
- Galvanized anchor Bruce with join (30Kg)
- Galvanized chain 75m 10mm
- Shower with mixer
- Stainless steel mooring cleat bow (2)
- Teak deck
- Windlass 2300 W with waterproof control pad

#### HELM STATION

- Autopilot integrated in plotter
- Bow thruster joystick
- Carbon look dashboard panels
- Chart-Plotter (2)
- Compass
- Electronic digital LCD engine control panel (2)
- Electronic levers for engine controls
- Engine room remote camera on plotter screen
- Helm wheel in Poltrona Frau leather
- Hideaway sliding hard top portion
- Instrument dashboard in GRP painted Nextel
- Integrated panel for alarms and electrical data management
- Pilot seat in Poltrona Frau leather
- Rudder angle, flap and trim panel
- Socket 12V (cigarette lighter type)
- SR trim joystick
- Trim tabs joystick
- VHF radio

- Windshield in transparent tempered glass
- Windshield wiper/washer (2)

#### SALOON

- Access to the night area through a stairway with parquet steps and courtesy lights
- Aft sofa in leather with drawers
- Audio video system
  - Hi-Fi system with 4 visible speakers and subwoofer
  - TV LED 32"
- Ceiling covered in vinilic fabric
- Ceramic set for 6 people
- Cutlery set for 6 people
- Digitally controlled A/C system
- Fabric roll curtains for side windows and sliding aft door
- Foldable dining table with manual movement
- Folding chairs (3) in leather
- Forward sofa with drawers
- Glasses set for 6 people
- Hideaway sliding aft door in black painted aluminium and crystal
- Led lights in the ceiling
- Refrigerator (42lt)
- Side windows in monolithic / stratified tempered glass
- Soft touch switch plates
- Structural GRP floor covered in parquet
- Teak holder for glasses and plates
- Unsealed ash wood furniture with opening doors and shelves

### ◆ LOWER DECK

#### GALLEY

- Ceramic glass hob with 4 burners
- Digitally controlled A/C system
- Dishwasher for 8 people
- Electric oven
- Electrical panel
- Extractor hood 110V-60Hz
- Faucet
- Fixed glass wall
- Floor covered by parquet
- Freezer
- Galley top in corian
- Lacquered ceiling
- Lacquered hanging lockers with internal shelf
- Led ceiling lights
- Light underneath shelves
- Opening porthole in stainless steel with mechanic hook
- Refrigerator (224lt)
- Rubbish bin
- Soft touch switch plates
- Stainless steel washbasin
- Under top lacquered unit furniture with opening doors, internal shelves and drawers

- Walls covered in laminate

#### CORRIDOR

- Ceiling panels covered with vinyl fabric
- Integrated system for alarms and electrical data management
- Led lights in the ceiling
- Mirror (2)
- Soft touch switch plates and sockets
- Structural GRP floor covered in parquet
- Walls covered in wallpaper

#### VIP CABIN

- Ash wood and wallpaper walls
- Blind compartments with vinyl finishing
- Ceiling with lacquered ceiling frame and panels upholstered in fabric vinyl
- Digitally controlled A/C system
- Double bed with bedframe upholstered in leather and drawer underneath
- Emergency exit to upper deck from circular hatchway
  - Blinder for hatchway
- Lacquered ivory interior door
  - Door handle with thumb lock
  - Door stops
- Leather panels above beahead
- Led lights in the ceiling
- Locker with lacquered doors, clothes rack and internal light (2)
- Manual rolls curtains in fabrics
- Mattress, pillows and bedcover
- Mirror at fore bulkhead
- Mirror at port
- Opening porthole in stainless steel with mechanic hook (2)
- Reading lights (2)
- Soft touch switch plates
- Structural GRP floor covered in moquette
- System HI-FI
- TV leather wall

#### VIP BATHROOM

- Clothes hook (2)
- Combined washbasin faucet
- Electric WC
- Floor in parquet
- Internal walls covered in laminate
- Lacquered ceiling
- Lacquered ivory interior doors
  - Door handles with thumb lock
- Lacquered washbasin unit with doors
- Led lights in the ceiling
- Manual Venetian blind in aluminium
- Mirror
- Opening portholes in stainless steel with mechanical hook



- Shower box covered with standard laminate and tempered glass
- Shower faucet with hand shower
- Shower floor in corian
- Soft touch switch plates
- Toilet brush holder
- Toilet roll holder
- Towel rail
- Wash basin

#### DOUBLE GUEST CABIN

- Ceiling with lacquered ceiling frame and panels upholstered in vinyl fabric
- Digitally controlled A/C system
- Lacquered ivory interior door
  - Door handles with thumb lock
  - Door stop
- Laminate blind compartments
- Leather panels above head
- Led ceiling lights
- Locker with lacquered doors, clothes rack and internal light
- Manual roll curtain in fabric
- Mattress, pillow and bedcover [2]
- Opening porthole in stainless steel with mechanic hook [2]
- Reading lights [2]
- Single bed in unsealed ash wood with leather lining and drawer underneath [2]
- Soft touch switch plates
- Structural GRP floor covered in moquette
- System mini HI-FI
- Unsealed ash wood
- Wallpaper TV wall
- Walls covered in unsealed ash wood and wallpaper

#### GUEST BATHROOM

- Clothes hook [2]
- Combined washbasin faucet
- Electric WC in ceramic
- Floor in parquet
- Internal walls covered in laminate
- Lacquered ceiling
- Lacquered ivory interior doors [2]
  - Door handles with thumb lock
  - Door stops
- Lacquered washbasin unit with doors
- Led ceiling lights
- Manual roll curtain in fabric
- Mirror
- Opening porthole in stainless steel with mechanical hook
- Shower box covered with standard laminate and tempered glass
- Shower faucet with height adjustable hand shower
- Shower floor in corian

- Soft touch switch plates
- Toilet brush holder
- Toilet roll holder
- Towel rail
- Wash basin

#### MASTER CABIN

- Ash wood furniture under tv with opening doors and mirror shelves
- Ash wood vanity furniture
- Audio video system
- Ceiling covered in vinyl fabric with lacquered frame
- Crossed leather wall above the bedhead
- Crossed leather walls on tv side
- Digitally controlled A/C system
- Double bed with bedframe in leather
- Lacquered ivory interior doors
  - Door handles with thumb lock
  - Door stops
- Lacquered nightstand [2]
- Laminate blind compartments
- Leather wall decor up bedhead
- Led lights in the ceiling
- Lockers in unsealed ash wood with clothes rack and internal light [2]
- Manual roll curtain in fabric
- Mattress, pillows and bedcover
- Mirror
- Mirror at aft bulkhead above bed
- Opening porthole in stainless steel with mechanical hook [2]
- Pouff
- Reading lights [2]
- Safe
- Side windows in monolithic tempered crystal [2]
- Sofa in leather with drawers
- Soft touch switch plates
- Structural GRP floor covered in moquette
- TV LED 32"
- TV wall lined with leather
- Walls covered in unsealed ash wood and wallpaper

#### MASTER BATHROOM

- Ceramic bidet
- Clothes hook [2]
- Combined washbasin and bidet faucet
- Corian shower plate
- Electric WC
- Internal walls covered in laminate
- Lacquered ceiling
- Lacquered hanging lockers with mirror
- Lacquered ivory interior door
  - Door handles with thumb lock
  - Door stop

- Lacquered washbasin unit with doors
- Led lights in the ceiling
- Manual Venetian blind in aluminium
- Opening portholes in stainless steel with mechanical hook
- Parquet floor
- Shower faucet with double outlets with deviator
- Shower walls covered with mosaic and tempered glass door
- Showerhead and shower handset
- Soft touch switch plates
- Toilet brush holder
- Toilet roll holder
- Towel rail [2]
- Wash basin in natural acrylic stone

#### CREW AREA

- CAPTAIN'S CABIN
  - Built in ceiling spotlight [2]
  - Ceiling covered in vinyl fabric
  - Digitally controlled A/C system
  - Lacquered wardrobe with doors
  - Laminate and vinyl blind compartments
  - Loudspeaker [2]
  - Mattress, pillow and bedcover
  - Mini Hi-fi
  - Moquette
  - Opening porthole in stainless steel with mechanical hook
  - Reading light
  - Single bed with drawers
  - Soft touch switch plates
  - Structural GRP floor with carpet
  - Walls covered with std laminate and panels upholstered in vinyl fabric
- CREW BATHROOM
  - Built in ceiling spotlight [2]
  - Clothes hook [2]
  - Door handles
  - Door stop
  - Electric WC in porcelain
  - Extractable shower with mixer tap
  - Fiberglass floor
  - Lacquered ceiling
  - Mirror
  - Satin glass door
  - Shower curtain
  - Shower floor in teak
  - Soft touch switch plates
  - Toilet brush holder
  - Toilet roll holder
  - Towel rail
  - Washbasin unit with opening doors and GRP top
  - Watertight door engine room access

#### ENGINE ROOM

- A/C unit
- Aluminum floor covered with anti slip material
- Coupling joint between adaptor and flange [2]
- Diesel engines MTU 10V 1623 mhp
- Dynamic air intakes
- E/pump A/C
- Electric extractor [2]
- Engine exhaust muffler [2]
- Engine room pillars [2]
- Fresh water outlet in engine room
- Generator manifold and gas separator [2]
- Gruppo elettrogeno 21.5kW 60Hz con cassa insonorizzante
- Hydraulic oil heat exchanger
- Hydraulic steering oil tank
- Hydraulic unit for steering, trims and trim tabs
- Hydraulic unit for swim ladder, aft sliding door, gangway and garage hatch
- Light switch
- Stainless steel engine exhaust raiser [2]
- Thermal acoustic insulation
- Waterproof fixed explosion-proof neon light [2]

#### PROPULSION AND

#### MANEUVERING

#### EQUIPMENT

- Bow thruster [10,7hp]
- Hydraulic steering
- Hydraulic trim tabs
- Surface drive system with trim [2]
- Surface propeller [2]

#### ◆ SYSTEMS

#### FRESH WATER SYSTEM

- Boiler 30lt - electric [2]
- Fresh water pump
- Level sensor
- Shore fresh water intake with pressure regulator
- Structural GRP main tank [900 lt]

#### SEA WATER SYSTEM

- By-pass valve for emergency bilge discharge from engines [2]
- Dynamic seawater intake [2]
- Fire extinguishing and chain wash e/pump
- Sea water basket filter for engines, power generators, A/C pumps, services and fire extinguishing system [5]
- Seawater outlet for chain wash and fire extinguishing in forward locker
- Static seawater intake [2]

#### ◆ TECHNICAL AREA

# PERSHING 70

## GREY WATER SYSTEM

- E/pump auxiliary tank discharge
- E/pump main tank discharge
- Level sensor
- Manifold by-pass for emergency pump discharge
- Structural GRP main tank (200 lt)

## BLACK WATER SYSTEM

- E/pump tank discharge
- Level sensor
- Manifold by-pass for emergency pump discharge
- Structural GRP tank (285lt)

## FIRE EXTINGUISHING SYSTEM

- Emergency engine shut down remote control
- Fire extinguishing system
- Manual /automatic extinguisher in engine room
- Manual powder extinguisher 1 Kg (1 for each room)
- Manual powder extinguisher 2 Kg in engine room

## AIR CONDITIONING SYSTEM

- Air Conditioning American version (outlet in the bathrooms included, 108.000 btu)

## ELECTRICAL SYSTEM

- Batteries cut-off
- Battery charger for engines
- Emergency parallel connection between services batteries and engines batteries
- Engine starter battery (4)
- Ground bonding system all along the hull joined to the anodes protection (zincs) on the transom
- Inverter for fridge and freezer
- Main electric panel with magneto-thermic switches
- Power generator starter battery
- Power shore socket 100A
- Service battery (4)
- Services battery charger
- Shore socket and loose cable
- Sockets 120V (1 for each room)
- Switchboard in dinette
- Voltage measuring instruments 24V

## FUEL SYSTEM

- Electronic fuel level remote indicator in dashboard
- Fuel precleaner (2)
- Manual fuel discharge/load drainage pump
- Structural GRP tank 3500l
- Visual fuel gauge

## BILGE SYSTEM

- Automatic immersion e/pump for bilge discharge in each compartment with level sensor
- Emergency bilge e/pump for each bilge compartment
- Emergency engine room bilge system discharge through engines intake suction
- Manual immersion e/pump for bilge discharge in each compartment with level sensor

## ◆ EQUIPMENT

- Bag with logo (2)
- Black mooring line Ø 22 (4 x 25 m)
- Cylindric fender with line (6)
- Diurnal navigation shapes mast
- Fender covers
- Floating luminous buoy
- INSTRUCTION and SERVICE Manual
- Life jacket (8)
- Life saver with floating line
- Means of unassisted reboarding
- Model indication plate XFA
- Pershing bath towel (6)
- Pershing towel set (6)
- Rigid, self inflating life raft for 8 people
- Safety hooks
- Spherical fender with line (2)
- Telescopic boat hook
- Weather station: clock, barometer, thermometer

This document shall not constitute in any circumstances whatsoever any offer by the shipyard to any person or be incorporated into any contract.

Any and all information contained in this document, including without limitation all technical data, performance, illustrations and drawings, are not contractual and refer to European standard models of motor yachts built by the shipyard and have been up-dated by the shipyard as of the date of issue of this document. The only valid technical reference or description is the specific parameters of each motor yachts cited only on purchase of the same. Therefore the only indications binding on the seller are contained solely in the sale agreement. This document is based on information available at the date of issue. Not with standing all efforts to insure accuracy, the information contained in this document may not cover all details, subsequent changes, not accurately foresee or report all possible scenarios. The shipyard reserves the right to modify its motor yachts and to substitute the manufacturers and/or the suppliers of any component and/or system and/or equipment due to product changes and/or improvements and/or availability of supply, changes in laws and/or regulations applicable, technology, know-how, provided that any substituted component and/or system and/or equipment of the motor yachts shall be of equivalent or superior quality to that shown in this Brochure. Displays, photos, schemes, designs or examples contained in this document are solely and exclusively reproduced to highlight the information contained. Due to the different characteristics of each yacht, the shipyard declines any and all liability for any use thereof on the basis of the information contained in this document.

This document and its contents may not be copied or reproduced and may not be modified or altered, in whole or in part.

The sale of this document and its contents is prohibited and no admitted.

Images may contain optional equipment or accessories, so do not necessarily comply with standard configuration.



**PERSHING**

*STAND OUT*

**PERSHING-YACHT.COM**

FERRETTI GROUP AMERICA LLC  
1445 S.E. 16<sup>TH</sup> STREET - FORT LAUDERDALE, FLORIDA 33316 USA  
PH. +1954 4625527 - FAX +1954 4625563