

PERSHING

AMAS

1000

PERSHING 108

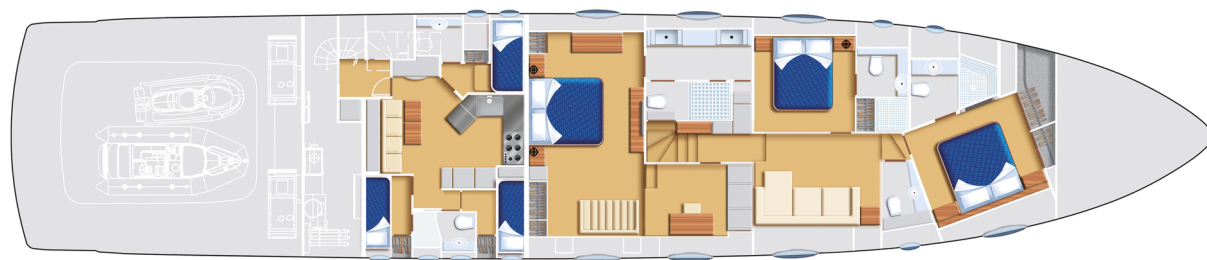
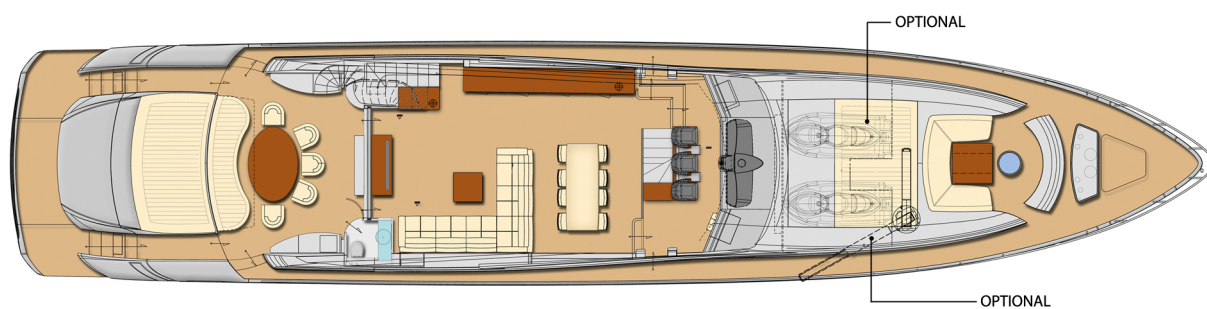
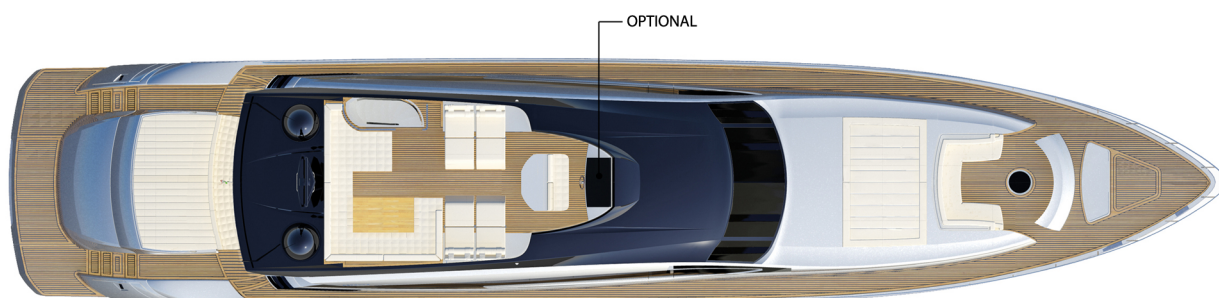

HULL, PROPULSION AND TECHNICAL PROJECT: FERRETTIGROUP ENGINEERING DEPARTMENT
YACHT DESIGNER: FULVIO DE SIMONI

EN TECHNICAL CHARACTERISTICS

ENGINES

3 x MTU 16V 2000 M96L Power 2638 mhp / 1939 kW at 2450 rpm - TS105

HULL TYPE

15° deadrise Monohedron hull with spray rails

LOA = Overall Length standard ISO 8666	109 ft. 0 in.
LH = Hull length standard ISO 8666	107 ft. 8 in.
LWL = Waterline length (boat fully laden)	84 ft. 9 in.
Maximum beam	22 ft. 0 in.
Overall height from keel to radar arch	27 ft. 1 in.
Ht = Minimum transport height from keel	23 ft. 4 in.
Displacement unladen	216273 lbs.
Displacement laden	248417 lbs.
Depth under propellers (boat fully laden)	6 ft. 0 in. ^[4]
P1 = fore appendages	1 ft. 2 in.
P2 = aft appendages	0 ft. 3 in.
Fuel tank capacity	3170 US Gals.
Water tanks capacity	528 US Gals.
Maximum number of people on board	20
Light displacement maximum speed = 1/3 laden	(MTU 2638) 42 knots ^[2]
Nr. Cabins	4
Nr. Bathrooms	5
Nr. Crew Cabins	3
Safety equipment	20 ^[3]
Certification documents	:H, Y, Unrestricted Navigation

STANDARD ISO 8666 

HULL/DECK CONSTRUCTION MATERIAL

Hull: construction from female mould with sandwich bottom and sides with balsa wood core; vinylester resin. Stratification of longitudinal stiffeners with polyurethane foam; stratification of transversal stringers with PVC core at bow, with polyurethane foam at stern.

Deck and superstructure: construction from mould with vacuum infusion lamination (PVC core sandwich and vinylester resin).

Main bulkheads and interior structural floors (excluding the engine room) with vacuum infusion lamination (PVC core sandwich and vinylester resin).

Areas of the deck such as: the bow area (except the mooring area), bow dinette, side decks, walking areas of the cockpit, swim platform and aft steps, are covered in teak sealed with polymerized black rubber caulking.

Other areas according to the position have an anti-slip or polished gelcoat finish such as hull and superstructure.

Structural tanks for fuel, fresh water, grey water are layared with vinylester resin.

STANDARD FURNITURE WOOD: Dark grey oak preformed wood [Alpi TBF 2B2382] with stainless steel details

PAINTING

The inside of the hull and the bilges are protected by gelcoat applied by brush. In particular, the area above the water line and the superstructure have a polished finish gelcoat (shipyard standard colour) shined by a process of abrasive paste and polish. Areas above the water line that are painted in a different colour according to the standard Pershing shipyard graphics are treated with a bi-component polyurethane paint in black colour. Submerged areas are treated with two coats antifouling paint for "high speed" hulls, after application of an epoxy primer.

(1) This technical specification is valid and refers to yacht ordered as 1 September 2020.

(2) Performances are approximative and they refer to the standard equipment of the boat, at 1/3 of load corresponding to ton 102,93 [226914 lb], performances estimated at the following conditions: calm sea, absence of wind, 25°C air temperature, clean hull and special propellers set for those conditions and 8 people on board. Overloading the yacht by 2,5 ton / 5512 lb top speed decreases of 1 knot.

(3) Pershing shipyard does not supply complete safety equipment as Pershing yachts are delivered to all countries. Owners must therefore complete the safety equipment with the devices required in their own specific country, Pershing can, however, supply safety equipment upon request.

(4) The stated draft is with the surface drives in the zero position.

PERSHING 108

STANDARD EQUIPMENT

◆ UPPER SUN DECK

- Bar furniture with fridge, barbecue, sink and dustbin
- Chaise longue (4)
- Double 120V internal sockets in every box
- Epirb
- Gas piston height-adjustable teak table
- Gate for stair
- GRP sofa with seats and backrest upholstered in vinyl fabric
- Hand shower with hose reel
- Lighting
- Loudspeaker (4)
- Side lockers (2)
- Stainless steel handrail Ø 40 mm
- Sun pad upholstered in vinyl fabric
- Teak floor
- VHF transceiver

ANTENNAS AREA

- Antenna radar open array
- Dome (2)
- GPS Antenna (2)
- GRP radar arch (radar support, antennas, signals)
- GSM antenna
- SAT TV antenna Ø 65 cm with dome
- Signal mast in stainless steel (black paint)
- TV antenna
- VHF antenna (2)
- Wind detector

◆ MAIN DECK

COCKPIT/OUTSIDE AFT

DINETTE

- Access to day head
- Chairs (5)
- Glass table with steel support
- GRP ceiling
 - Ceiling lights
 - Loudspeakers (2)
 - Waterproof camera (2)
- GRP central furniture
- GRP furniture stbd side with sink
 - Fridge 85L
 - Ice maker
- Sofa with seats and backrest upholstered in vinyl fabric
- Sun pad upholstered in vinyl fabric with seat
 - Sun pad handrail
- Teak cockpit flooring

ACCESS TO CREW

QUARTER AND ENGINE

ROOM THROUGH GRP LADDER

- GRP furniture port side

ACCESS TO SUN DECK

- External GRP stairs for access to the sun deck with teak steps
- GRP access door to sun deck stairs

ACCESS TO THE BATHING

PLATFORM

- GRP port stairs with teak steps
 - Fresh water mixer tap and shower
 - Shore water plug
 - Stainless steel gate for cockpit entry
 - Water loading dock
- GRP starboard stairs with teak steps
 - Gate in stainless steel
 - Glendinning electric shore connection 100A 400V 3 poles + ground (20M)
 - Shore plug
 - Telescopic hydraulic hideaway gangway with remote control
- Teak floor
 - Hydraulic hideaway swim ladder in bathing platform
 - Stainless steel mooring cleat at stern (4)
 - Swimming platform underwater lighting (2)

AFT GARAGE

- Garage door
- Jetski Seadoo Spark 3UP-950HO iBR
- Kit hydraulically powered tailgate
- Tender and jet ski towing system
- Tender Zodiac Projet 420
- Waterproof fixed explosion-proof neon light (3)

AFT MOORING STATION

- Capstan 2500W, electric, with foot control (2)
- Fairlead in stainless steel with rolls (2)
- Stainless steel mooring cleat (4)

ANCHORING AND

MOORING BOW

- Access to bow locker with hatch
- Bow locker
- Fairlead in stainless steel (4)
- Galvanized anchor (105kg, type POOL TW) (2)
- Galvanized chain (2) 165m and 100m 13mm
- Stainless steel hawse port-stb
- Stainless steel mooring cleat (4)
- Windlass 2700 W with waterproof control pad (2)

BOW GARAGE

- Garage door
 - Access through hatchway

- Sunlounge pad at bow with cushions
- Waterproof fixed explosion-proof neon light (1)

SIDE WALKWAYS

- Courtesy led light
- Electric pantograph side door (2)
- Fuel filling cap (2)
- Side "Pershing 108" Logo in silicon (2)
- Side locker with closure (2)
- Stainless steel handrail on side of superstructure (2)
- Stainless steel railing Ø 40 mm with stanchion Ø 35 mm and hooking points
- Stainless steel retractable mooring cleat at midship (2)
- Stainless steel rubrail
- Walkways: wood covered

OUTSIDE FORWARD

DINETTE

- Amplifier and Loudspeakers
- Courtesy led lighting
- Dinette cover with hydraulic movement
- GRP seat at bow upholstered in vinyl fabric
- GRP sofa with seats and backrest upholstered in vinyl fabric
- Hand shower with hose reel
- Hinged circular hatchway in stainless steel and crystal glass with handle
- Hydraulic piston height-adjustable grp table

DAY HEAD

- Electric WC
- GRP door
- Lacquered ceiling
- Led lighting (2)
- Light switches soft touch panel
- Mirror
- Soap dish
- Teak floor
 - Emergency exit
 - Fiberglass and wooden door
- Toilet roll holder
- Towel rack
- Venetian blinds
- Washbasin lacquered and glass top
 - Combined washbasin mixer tap
 - Washbasin
- WC brush holder

UPPER SALOON

- Access to the galley and crew quarter
 - Handrail
 - Stairway with natural wood steps
- Access to the night area through a stairway with natural wood steps and handrail

- Handrail
- Stairway with natural wood steps
- Audio video system:
 - SAT/TV decoder
 - TV LED 55" (2) hideaway for saloon and cockpit
- Chairs (8)
- Coffee table
- Cordless telephone
- Digitally controlled A/C system
- Dining set for 12 people
- Dining table
- Electric fabric curtains
- Hi-Fi system
 - Amplifier
 - Sound system with four visible speakers, two TV speakers and subwoofer
- Lateral walls upholstered with Poltrona Frau leather
- LED ceiling lights
- Light switch with dimmer
- Ottomans upholstered in Poltrona Frau leather
- Paneled ceiling upholstered in leather fabric and lacquered wood
- Poltrona Frau leather sofa
- Rug under the sofa as per shipyard standard
- Side windows in monolithic/stratified tempered glass
- Single remote control for the entire saloon audio-video system
- Structural GRP floor covered in wood
- Table lamp (2)
- Windshield in transparent tempered glass
- Windshield wiper/washer (2)
- Wood furniture with opening doors and internal shelves port
 - Minibar
 - Rack Audio-Video

HELM STATION

- AIS Furuno
- Alarms and NAVIOP electric data unit
- Aluminum panels with carbon fiber finishing
- Autopilot
- Bow thruster joystick
- CCTV display with cyclic selector
- Coastal internet system (GPRS / UMTS), data system WIFI / LAN
- Compass
- Co-pilot seat upholstered with Poltrona Frau leather with double electric control (2)
- Depth/speed/wind indicators
- Digital bar angle indicator, flaps, trims
- Digital controlled A/C panels
- Display Chart Plotter/Black Box Furuno 3D (2)

- Electric panel
- Electronic digital LCD engine control panel (3)
- Electronic levers for engine control (2)
- Engine and navigation control instruments
- Glove compartments (2)
- GSM Tel/Fax telephone system
- Helm wheel in Poltrona Frau leather
- Instrument dashboard upholstered in leather
- Light switch with dimmer
- Navtex
- Panel for fire detection system
- Pilot seat upholstered with Poltrona Frau leather with double electric control
- Radio VHF (2)
- Radiofrequency portable intercom (4)
- Sart Trasponder
- Socket (cigarette lighter type) 12V (2)
- Surface propellers trim joystick
- Synoptic panel
- Tiller joystick
- Trim tabs joystick

◆ LOWER DECK

CORRIDOR

- Built in wardrobe on corridor access port bulkhead
 - Rack Audio-Video
- Built in wardrobe on corridor access port bulkhead with shelves
- Ceiling panels covered with vinyl fabric
- Courtesy LED lights
- LED ceiling with indirect lights
- Light switches soft touch panel
- Mirror
- Panels upholstered with leather and back LED light (2)
- Partitions covered in wood
- Structural GRP floor covered with moquette

MASTER CABIN

- Armchair for beauty unit P.Frau
- Armchair for desk P.Frau
- Beauty unit port side in wood with mirror made Poltrona Frau
 - Frigo-bar
 - Lamp
- Built in ceiling LED indirect lights
- Ceiling panels covered with vinyl fabric and lacquered wood ceiling frame
- Chaise longue
- Cordless telephone
- Desk with pull out shelf P.Frau
 - Lamp
- Digitally controlled A/C system

- Dimmer
- Double bed in wood and P.Frau leather, with locker underneath
- Electric fabric curtains
- Electric roller blackout curtains
- Fixed side windows in tempered glass and (3) opening porthole in stainless steel and tempered glass
- Hi-Fi system
 - Amplifier
 - Dolby surround system with 5+1 speakers
 - Full A/V remote control
 - Rack Audio-Video
 - SAT/TV decoder
- Interior doors in wood
 - Chrome door stops for interiors
 - Door handle with thumb lock
- Leather bed headborder P.Frau
- LED TV 49"
- Lockers with doors in wood, with clothes rack, shelves and internal light
- Mattress, pillows and bedcover
- Mirror(2)
- P.Frau Leather night table (2)
- Reading light (2)
- Safe
- Stern bulkheads sound insulation at stern
- Structural GRP floor covered in carpet
- TV panel upholstered with leather P.Frau
- Walls covered in wood

MASTER BATHROOM

- Bidet
- Ceiling with indirect lighting
- Clothes hook (2)
- Combined washbasin (2) and bidet faucets
- Digitally controlled A/C system
- Door to WC area in crystal
- Electric WC
- Fixed side windows in tempered glass and opening porthole in stainless steel and tempered glass
- Hanging locker with mirror (2)
- Interior doors in wood
 - Chrome door stops for interiors
 - Door handle with thumb lock
- Lacquered ceiling
- Loudspeaker
- Manual aluminum Venetian blinds
- Shower box
 - Crystal shower door
 - Multifunction ceiling showerhead and shower handset
 - Shower walls, floor and seat in mosaic
- Soap dish (2)

- Toilet roll holder
- Toothbrush holder (2)
- Towel cabinet with glass door and internal shelves
- Towel rack (6)
- Walls covered in wood
- Washbasin (2)
- Washbasin furniture in wood and coloured glass top, with doors and shelves
- WC brush holder
- Wooden floor

VIP CABIN

- Audio-Video system :
 - Built-in loudspeaker (2) + subwoofer
 - LED TV 40"
 - TV/SAT decoder
- Built in LED ceiling indirect lights
- Closet in wood with clothes rack, internal light and mirror
 - Cabinet with drawers
 - Safe
- Cordless telephone
- Digitally controlled A/C system
- Dimmer
- Double bed with headborder upholstered in Poltrona Frau leather and locker underneath and drawers
- Electric fabric curtains
- Electric roller blackout curtains
- Emergency exit to upper deck from circular hatchway and hideaway ladder
- Full A/V remote control
- Hanging locker in wood
- Interior doors in wood
 - Chrome door stops for interiors
 - Door handle with thumb lock
- Mattress, pillow and bedcover
- Opening porthole in stainless steel and tempered glass
- Panelled ceiling upholstered in vinyl fabric and lacquered wood
- Reading light (2)
- Sliding blind for hatchway
- Structural GRP floor covered with carpet
- TV panel with upholstery in P.Frau leather
- Walls covered in wood
- Wood nightstand with leather top (2)

VIP BATHROOM

- A/C system outlet
- Air extraction outlet
- Bidet
- Built in LED ceiling spotlights
- Clothes hook (2)
- Combined washbasin faucets
- Electric WC
- Furniture top in glass
- Hanging locker in wood
- Hanging locker with mirror

- Interior doors in wood
 - Chrome door stops for interiors
 - Door handle with thumb lock
- Light switches soft touch panel
- Manual aluminum Venetian blinds
- Mirror
- Opening porthole in stainless steel and tempered glass
- Shower box
 - Crystal shower door
 - Shower walls, floor and seat in mosaic
 - Showerhead and shower handset
- Soap dish
- Toilet roll holder
- Toothbrush holder
- Towel rack (2)
- Walls covered in wood
- Washbasin
- Washbasin furniture in wood, with doors and shelves
- WC brush holder
- White lacquered ceiling
- Wooden floor

PORT DOUBLE GUEST CABIN

- Audio-Video system :
 - Built in loudspeaker (2)
 - LED TV 32"
 - Mini Hi-Fi CD/DVD
 - TV/SAT decoder
- Ceiling panels covered with vinyl fabric and lacquered wood ceiling frame
- Digitally controlled A/C system
- Electric fabric curtains
- Electric roller blackout curtains
- Hanging in wood
- Intercom cordless system
- Interior doors in wood
 - Chrome door stops for interiors
 - Door handle with thumb lock
- Leather bed headborder
- LED ceiling indirect lights
- Light switches soft touch panel
- Mattress, pillow and bedcover
- Mirror at aft bulkhead
- Opening porthole in stainless steel and tempered glass
- Structural GRP floor covered with carpet
- TV panel with upholstery in leather P.Frau
- Twin beds convertible into a double bed in wood and leather Poltrona Frau (2), with drawers
- Wall light (2)
- Walls covered with wood
- Wardrobe in wood with clothes rail and internal light
- Wood nightstand with leather top (2)

PORT GUEST BATHROOM

PERSHING 108

- A/C system outlet
- Air extraction outlet
- Built in LED ceiling spotlights
- Clothes hook (2)
- Combined washbasin and bidet faucets
- Electric WC
- Furniture top in glass
- Hanging locker in wood (2)
- Interior doors in wood
 - Chrome door stops for interiors
 - Door handle with thumb lock
- Light switches soft touch panel
- Manual aluminum Venetian blinds
- Mirror
- Opening porthole in stainless steel and tempered glass
- Shower box
 - Crystal shower door
 - Shower walls and floor in mosaic
 - Showerhead and shower handset
- Soap dish
- Toothbrush holder
- Towel rack
- Walls covered in wood
- Washbasin
- Washbasin furniture in wood, with doors and shelves
- WC brush holder
- White lacquered ceiling
- Wooden floor

STARBOARD DOUBLE GUEST CABIN

- Applique (2)
- Audio-Video system :
 - Built in loudspeaker (2)
 - LED TV 32"
 - Mini Hi-Fi CD/DVD
 - TV/SAT decoder
- Ceiling panels covered with vinyl fabric and lacquered wood ceiling frame
- Digitally controlled A/C system
- Electric fabric curtains
- Electric roller blackout curtains
- Hanging locker in wood
- Intercom cordless system
- Interior doors in wood
 - Chrome door stops for interiors
 - Door handle with thumb lock
- Leather bed headboard
- LED ceiling indirect lights
- Light switches soft touch panel
- Mattress, pillow and bedcover
- Opening porthole in stainless steel and tempered glass
- Single bed in wood and leather (2), with drawers
- Structural GRP floor covered with carpet
- TV panel upholstered with leather P.Frau

- Walls covered in wood
- Wardrobe in wood with clothes rail and internal light
- Wood nightstand with leather top

STARBOARD GUEST BATHROOM

- A/C system outlet
- Air extraction outlet
- Built in LED ceiling spotlights
- Closet in wood with shelves near wc
- Clothes hook (2)
- Combined washbasin faucets
- Electric WC
- Furniture top in glass
- Glass shelves (4)
- Hanging in wood lockers in with door in mirror and shelves
- Interior doors in wood
 - Chrome door stops for interiors
 - Door handle with thumb lock
- Light switches soft touch panel
- Manual aluminum Venetian blinds
- Mirror
- Opening porthole in stainless steel and tempered glass
- Shower box
 - Crystal shower door
 - Shower floor and seat in mosaic
 - Showerhead and shower handset
- Soap dish
- Toilet roll holder
- Toothbrush holder
- Towel rack (2)
- Walls covered in wood
- Washbasin
- Washbasin furniture in wood, with doors and shelves
- WC brush holder
- White lacquered ceiling
- Wooden floor

GALLEY

- Access to crew quarter
- Built in ceiling LED lights and built in spotlights underneath shelves
- Ceramic glass hob with 4 burners
- Digitally controlled A/C system
- Dishwasher for 12 people
- Electric vented oven with tempered glass and stainless steel door
- Extractor fan 230V with external outlet
- Galley top in acrylic stone
- Hanging locker door and internal shelves
- Lacquered ceiling
- Light switches soft touch panel
- Microwave oven
- Mixer tap
- Rubbish bin

- Side by side fridge
- Stainless steel washbasin
- Structural floor fiberglass coated vinyl material
- Under top unit with glass opening doors and internal shelves

CREW DINETTE

- Access to engine room
- Access to salon through stairs
- Audio video system
 - Built in loudspeaker (2)
 - LED TV 24"
 - Mini Hi-Fi
- Built in ceiling LED lights
- Decoder Sat Tv
- Display touch-screen for cameras
- Dryer
- Floor covered in vinyl material
- Folding table with handling gas piston
- Hanging lockers lacquered with opening doors internal shelves
- Integrated monitoring system for alarms and electrical data
- Intercom system
- Interior doors and frames ivory lacquered in crew quarter
 - Chrome door stops for interiors
 - Door handle with thumb lock
- Lacquered ceiling
- Light switches soft touch panel
- Pouff upholstered in vinyl fabric
- Sofa upholstered in vinyl fabric
- VHF transceiver
- Walls upholstered in vinyl fabric
- Washing machine

CAPTAIN'S CABIN

- Audio video system:
 - LED TV 24"
 - Loudspeakers (2)
 - Mini Hi-Fi CD/DVD
- Built in ceiling spotlight
- Ceiling panels upholstered in vinyl fabric
- Cupboard with internal shelves
- Digitally controlled A/C system
- Ivory lacquered door
 - Chrome door stops for interiors
 - Door handle with thumb lock
- Light switches soft touch panel
- Locker with lacquered doors with clothes rack and internal light
- Manual aluminum Venetian blind
- Mattress, pillow and bedcover
- Opening porthole in stainless steel and tempered glass
- Phone intercom
- Reading light
- Safe
- Single bed with drawers underneath

- Structural GRP floor covered with carpet
- Walls covered with vinyl fabric

CAPTAIN'S BATHROOM

- Built in ceiling spotlight
- Clothes hook
- Electric WC in porcelain
- Floor covered in vinyl material
- Interior door ivory lacquered
 - Chrome door stops for interiors
 - Door handle with thumb lock
- Lacquered ceiling
- Lacquered washbasin unit with opening doors
- Laminated walls
- Opening porthole in stainless steel and tempered glass
- Shower box with pole, teak floor and door in plexiglass
 - Shower faucet
- Soap dish
- Toilet brush holder
- Toilet roll holder
- Towel rack
- Wood hanging lockers with door, mirror and shelves

DOUBLE CREW CABIN (BOW SIDE)

- Built in ceiling spotlights
- Digitally controlled A/C system
- Interior doors and frames ivory lacquered in crew quarter
 - Chrome door stops for interiors
 - Door handle with thumb lock
- Locker with lacquered doors with clothes rack and internal light
- Loudspeaker (2)
- Lower single bed with drawers underneath
- Manual aluminum Venetian blind
- Mattress, pillow and bedcover (2)
- Mini Hi-Fi Cd
- Opening porthole in stainless steel and tempered glass
- Paneled ceiling upholstered in vinyl fabric
- Reading light (2)
- Structural GRP floor covered in carpet
- Upper single bed
- Walls covered with vinyl fabric

DOUBLE CREW CABIN (STERN SIDE)

- Built in ceiling spotlights
- Ceiling panels upholstered in vinyl fabric
- Digitally controlled A/C system
- Interior doors and frames ivory lacquered in crew quarter
 - Chrome door stops for interiors
 - Door handle with thumb lock

- Locker with lacquered doors with clothes rack and internal light
- Loudspeaker (2)
- Lower single bed with chest of drawer
- Manual aluminum Venetian blind
- Mattress, pillow and bedcover (2)
- Mini Hi-Fi CD
- Opening porthole in stainless steel and tempered glass
- Reading light (2)
- Structural GRP floor covered in carpet
- Upper single bed
- Walls covered with vinyl fabric

CREW BATHROOM

- Built in ceiling spotlight
- Clothes hook
- Electric WC in porcelain
- Floor covered in vinyl material
- Interior doors ivory lacquered
 - Chrome door stops for interiors
 - Door handle with thumb lock
- Lacquered ceiling
- Lacquered Hanging wood lockers in with door in mirror and shelves
- Lacquered washbasin unit with opening doors
- Laminated walls
- Opening porthole in stainless steel and tempered glass
- Shower box with handshower and plexiglass door
 - Shower faucet
- Soap dish
- Toilet brush holder
- Toilet roll holder
- Towel rack

◆ TECHNICAL AREA

CONTROL ROOM

- Access to control room from engine room and from cockpit
- Certified water proof door
- Intercom telephone
- Waterproof camera interfaced with helm station
- Waterproof fixed explosion-proof neon light (3)

ENGINE ROOM

- Access to engine room from galley and from cockpit
- Air intakes with condensation removal system
- Certified waterproof door
- Coupling joint between gear box flange and surface propeller flange (3)
- Diesel engine MTU 16V 2638 mhp (3)
- E/pumps for A/C
- Electric extractor (2)

- Engine exhaust muffler (3)
- Floor covered with aluminum non-skid surface
- Generator manifold and gas separator (2)
- Hydraulic oil heat exchanger (3)
- Hydraulic units for gangway, garage door, aft door and swim ladder
- Light switch
- Power generator 33kW 50Hz with soundproof housing (2)
- Protective cover added to coupling
- Stainless steel engine exhaust raiser (3)
- Stainless steel protection rail around the engines (4)
- Thermal acoustic insulation
- Water maker 180 lt/h
- Waterproof camera interfaced with helm station (2)
- Waterproof fixed explosion-proof neon light (4)

PROPULSION AND MANOEUVRING EQUIPMENT

- Blades 6 Nickel – Aluminum – Bronze propeller (3)
- Hydraulic bow thruster
- Hydraulic flaps
- Hydraulic steering
- Surface drive system with trim

◆ SYSTEMS

FRESH WATER SYSTEM

- Boiler 50l - 230V for crew bathrooms
- Boiler 80lt - 230V for guest cabins (2)
- Fresh water outlet in engine room
- Fresh water outlet in fore peak
- Fresh water outlet in the garage
- Fresh water pump (2)
- Level sensor
- Structural GRP tank (2000lt)
- Water intake connected to main fresh water tank

SEA WATER SYSTEM

- By-pass valve for emergency bilge discharge from engines
- Dynamic sea water intake
- Fire extinguishing and chain wash e/pump
- Fire hose
- Sea water basket filter for engines, power generators, A/C pumps, services and fire extinguishing system
- Sea water outlet fire fight system
- Sea water outlet for chain wash and fire extinguishing in forward locker
- Static sea water intake

GREY WATER SYSTEM

- E/pump A/C condensation tank discharge
- E/pump auxiliary tank discharge
- E/pump main tank discharge
- GRP auxiliary tank
- Level sensor
- Structural GRP main tank (750lt)

BLACK WATER SYSTEM

- Diverter for "Marpol" flange
- E/pump tank discharge
- Level sensor
- Structural GRP tank (750lt)

FIRE EXTINGUISHING SYSTEM

- Delay bottle for air intake closure and alarm siren activation
- Emergency engine shut down remote control
- Fire fighting system and alarm activation remote control
- Fixed FM200 extinguishing system in engine room
- Manual powder extinguisher in engine room
- Manual powder extinguishers 1 Kg (1 for each room)

AIR CONDITIONING SYSTEM

- Digitally control A/C system in all cabins and upper saloon
- Mediterranean air conditioning system

ELECTRICAL SYSTEM

- Automatic battery charger for emergency battery
- Automatic battery charger for engine
- Automatic battery charger for service (2)
- Batteries cut-off
- Battery charger for generators
- Battery charger for radio
- Bonding plates
- Double 120V internal sockets in every box
- Earthing system all along the hull joined to the anodes protection (zincs) on the transom
- Electric panels for power distribution
- Emergency equipment battery (2)
- Emergency parallel connection between engine starter batteries
- Engine starter battery (6)
- Main electric panel with magneto-thermic switches and shore power panel
- MTU electronic LCD digital panels for engine control (3)

- Power generator starter battery (2)
- Radio equipment battery (2)
- Service battery (12)
- Shore power transformer 100A
- Shore socket and cable with "CABLE MASTER" Glendenning 100A
- Voltage measuring instruments 24V/ 230V/ 400V

FUEL SYSTEM

- Electronic fuel level remote indicator in dashboard
- Fuel precleaner (5): for engines (3), for generators (2)
- Fuel sight gauge
- Manual fuel discharge/load drainage pump
- Structural 12000 lt GRP tank 12000l

BILGE SYSTEM

- Automatic /manual immersion e /pump for bilge discharge in each compartment with level sensor (6)
- E/pump with valve system for the separated or joint bilge or fire extinguishing centralized suction system (2)
- Emergency engine room bilge system discharge through engines intake suction

◆ EQUIPMENT

- Bag with logo (2)
- Bed sheets, complete set
- Black mooring line Ø 30mm (4x 25m, 1x 50m)
- Floating luminous buoy (2)
- INSTRUCTION and SERVICE Manual
- Life jacket (16)
- Life saver with floating line
- Pershing bath towel (8)
- Rigid, self inflating life raft for 8 people (4)
- Set of canvas covers for windshield
- Set Pershing towel (8)
- Spherical Fender and cover with line diam 610 mm (10)
- Telescopic boat hook (2)
- Weather station: clock, barometer, thermometer

This document shall not constitute in any circumstances whatsoever any offer by the shipyard to any person or be incorporated into any contract.

Any and all information contained in this document, including without limitation all technical data, performance, illustrations and drawings, are not contractual and refer to European standard models of motor yachts built by the shipyard and have been up-dated by the shipyard as of the date of issue of this document. The only valid technical reference or description is the specific parameters of each motor yachts cited only on purchase of the same. Therefore the only indications binding on the seller are contained solely in the sale agreement. This document is based on information available at the date of issue. Notwithstanding all efforts to insure accuracy, the information contained in this document may not cover all details, subsequent changes, not accurately foresee or report all possible scenarios. The shipyard reserves the right to modify its motor yachts and to substitute the manufacturers and/or the suppliers of any component and/or system and/or equipment due to product changes and/or improvements and/or availability of supply, changes in laws and/or regulations applicable, technology, know-how, provided that any substituted component and/or system and/or equipment of the motor yachts shall be of equivalent or superior quality to that shown in this Brochure. Displays, photos, schemes, designs or examples contained in this document are solely and exclusively reproduced to highlight the information contained. Due to the different characteristics of each yacht, the shipyard declines any and all liability for any use thereof on the basis of the information contained in this document.

This document and its contents may not be copied or reproduced and may not be modified or altered, in whole or in part.

The sale of this document and its contents is prohibited and no admitted.

Images may contain optional equipment or accessories, so do not necessarily comply with standard configuration.

