

# Navetta 38

CRUISING INTO THE BEAUTY  
OF A NEW ARTWORK.

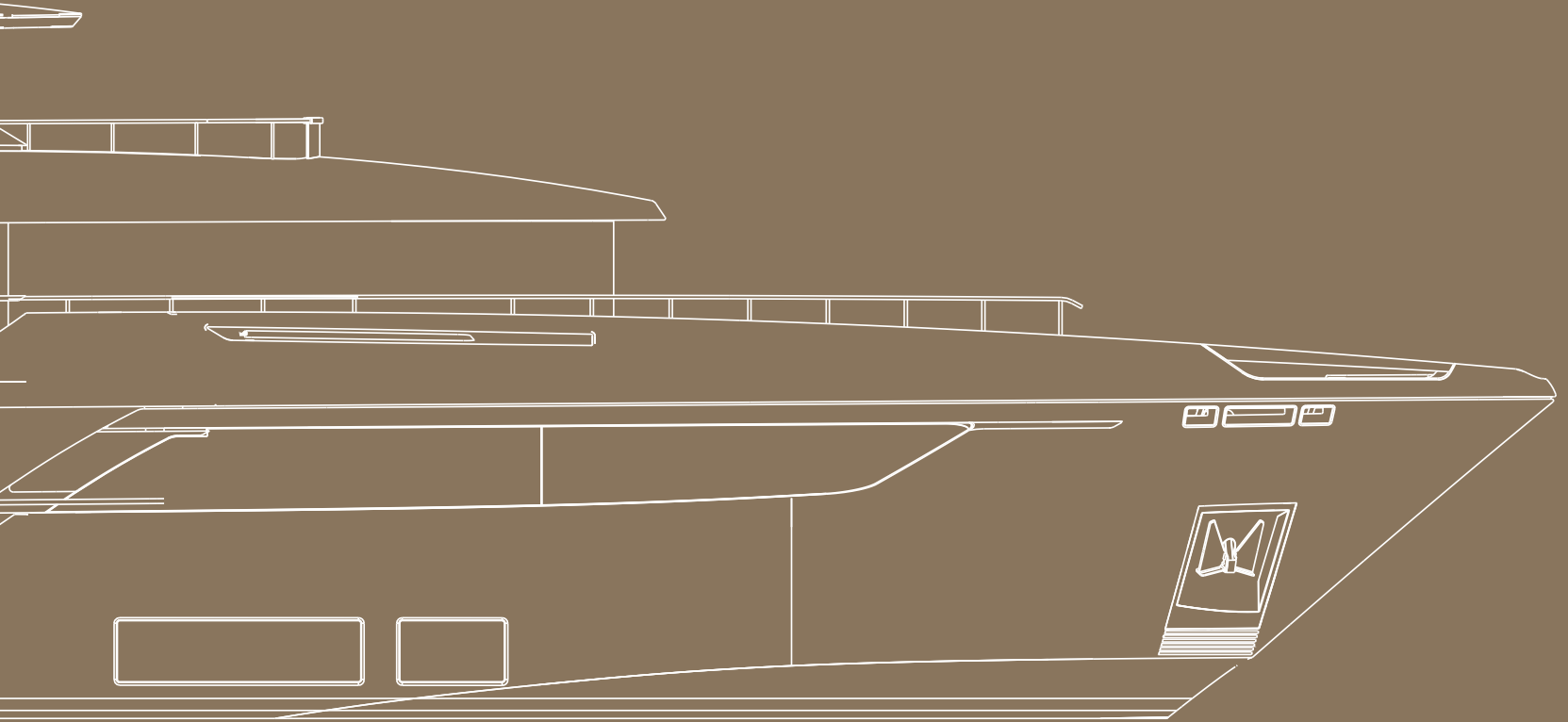

**CUSTOM LINE**

# Navetta 38 project

NAVAL ARCHITECTURE

*by Ferretti Group Engineering*

EXTERIOR DESIGN

*by Filippo Salvetti*

INTERIOR ARCHITECTURE

*by Antonio Citterio Patricia Viel*

# Beyond the line.

Some people stop  
at the superficial;  
we strive to go beyond.  
Because only those  
who cruise know  
where to find the sublime:  
Beyond the surface.  
**Beyond the Line.**

See another sea with  
the **Custom Line Navetta 38**.  
A reflection of  
the owner's personality,  
she's more than a yacht;  
she's a unique masterpiece.  
Because cruising is an art.  
The art of being different.



Some  
people see  
fragments;

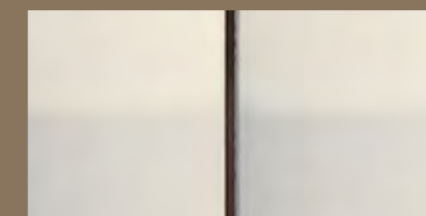
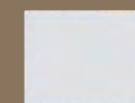
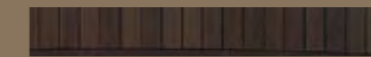
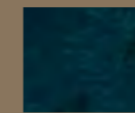
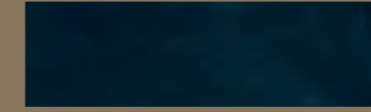

we see  
a unique creation.





The **Custom Line**  
**Navetta 38**

is the sublime new project for our semi-displacement range. An extraordinary place where freedom and dreams take wing on a beautiful journey in intimate touch with the sea.









## Facts & figures.

**15** knots

maximum speed

**12** knots

cruising speed

**2.800** nm

range

38 metres of pure Custom Line Navetta style, a new addition to our family of semi-displacement masterpieces.





**The stern area** is a unique feature aboard the Navetta 38, an entirely new concept of the full-beam beach deck. Complementing the broader stairs, foldable bulwarks and oversized beach sofa, the two side terraces open up to transform the beach area into an even larger multipurpose space at the water's edge.



A **four-deck superyacht** with one essential mission: to elevate the on-board experience to supreme new heights.



Some  
people see  
forms;



we see  
an art form.







Spanning a full 70 sqm and at 15 metres in length, **the expanded sun deck becomes a stunning space for conviviality**, contemplation and relaxation. It features a spectacular aft sea-view jacuzzi with sun pad, a sun lounge area at the bow, and a formal al fresco dining zone sheltered by a newly improved painted hard top.









Bathed in natural light, the immense **sky lounge** is the focal point of the Navetta 38 upper deck. The entire area is surrounded by large floor-to-ceiling windows offering magnificent wraparound views.





The **main saloon** is furnished with some exquisite free-standing furniture. The owner can host up to 10 guests for a formal dinner with luminous seascapes for company, courtesy of the full-height walk-through windows on each side that maintain a seamless connection between inside and out.





With almost 40 sqm of superlative comfort and amenity, the full-beam **master cabin** at the bow on the main deck offers a double his-and-hers walk-in wardrobe at the entrance and the enveloping sensation of home.













The **lower-deck** guest area is generously elegant, with nearly 60 sqm of space. The 8 comfortable berths are distributed across 1 guest and 3 VIP cabins, all with ample storage for a limitless ocean experience.



# Technical data

## Preliminary

Length overall (ISO 8666)	38,76 m   127 ft. 2 in. ft
Waterline Length (full load)	33,89 m   111 ft. 2 in. ft
Beam max	7.90 m   25 ft. 11 in. ft.
Max Draft (to propeller or to the lowest point including the appendages at even keel)	2,27 m   7 ft. 5 in. ft.
LightShip	200 t   440925 lbs.
Half Load Displacement (1)	219 t   482989 lbs
Full Load Displacement (2)	241 t   531314 lbs.
Gross tonnage (ITC 1969)	299 GT
Fuel tank capacity	34000 l   8982 US Gals.

Fresh water capacity	4000 l   1057 US Gals.
Grey water capacity	1500 l   396 US Gals.
Black water capacity	1500 l   396 US Gals.
Maximum speed	15 knots
Cruise speed	12 knots
Range at cruise speed (3)	1900 n.m.
Range at 10kn	2800 n.m.
Accommodation for Owner & Guests	5
Accommodation for Crew	4

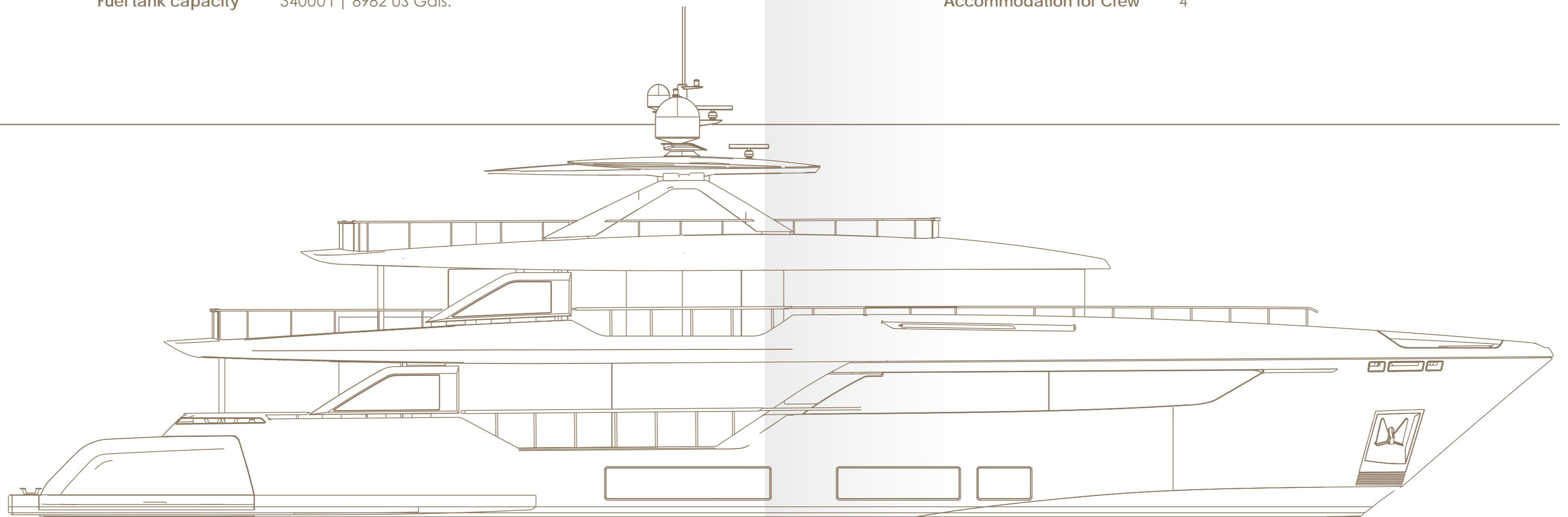



Navetta 38  
Project

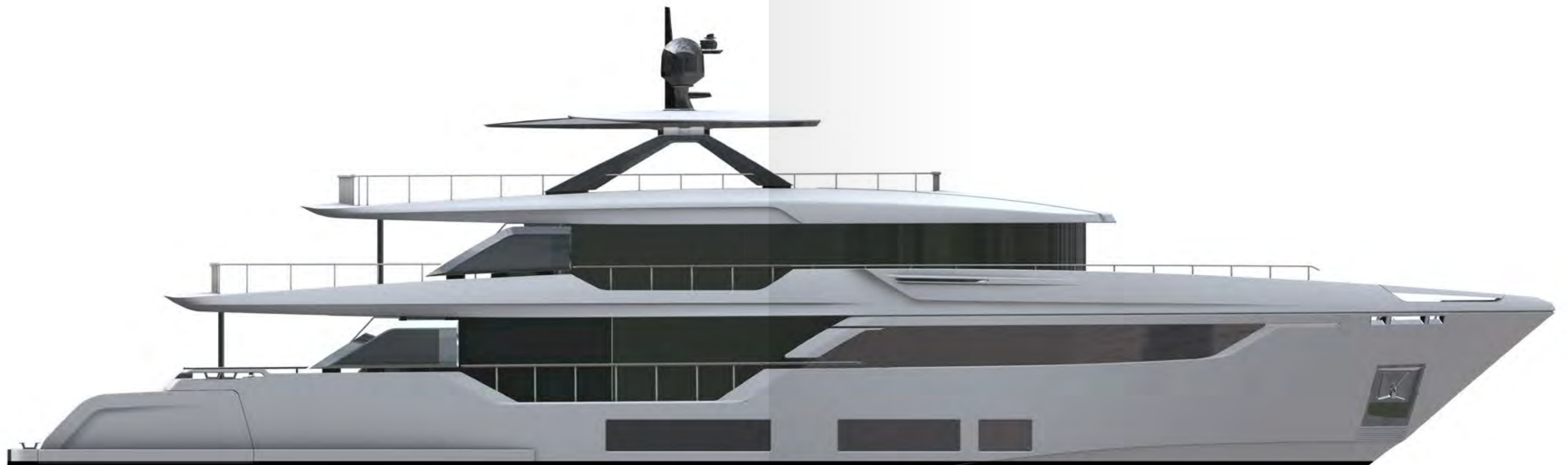

**WHERE YOUR STYLE MEETS CUSTOM LINE  
ATELIER EXCELLENCE**

The Custom Line Atelier is our strategic team of talented designers who support the owner right from the initial brief, to develop the yacht interior and tailor it to their personal taste. Make your yacht a unique work of art suffused with your individual style inspirations for an ambience that is 100% you.

Sun deck

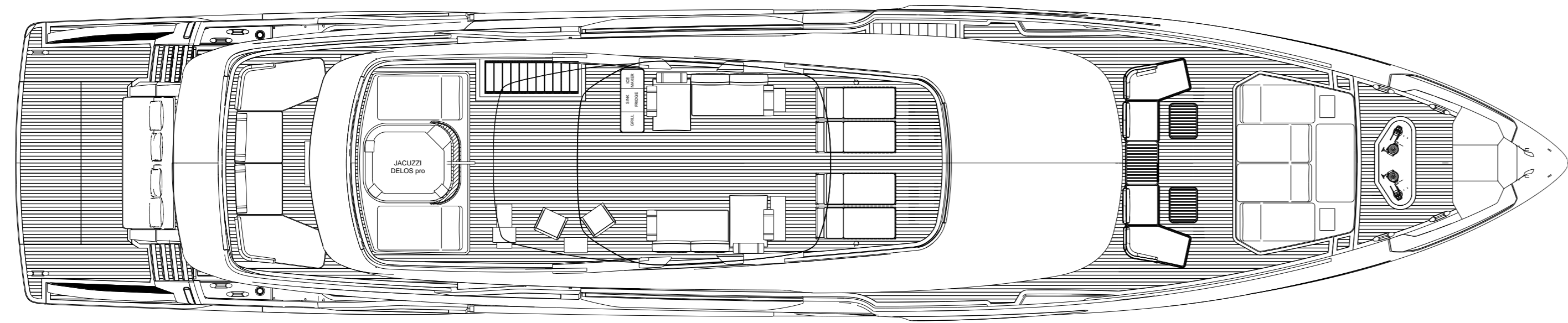

Main deck

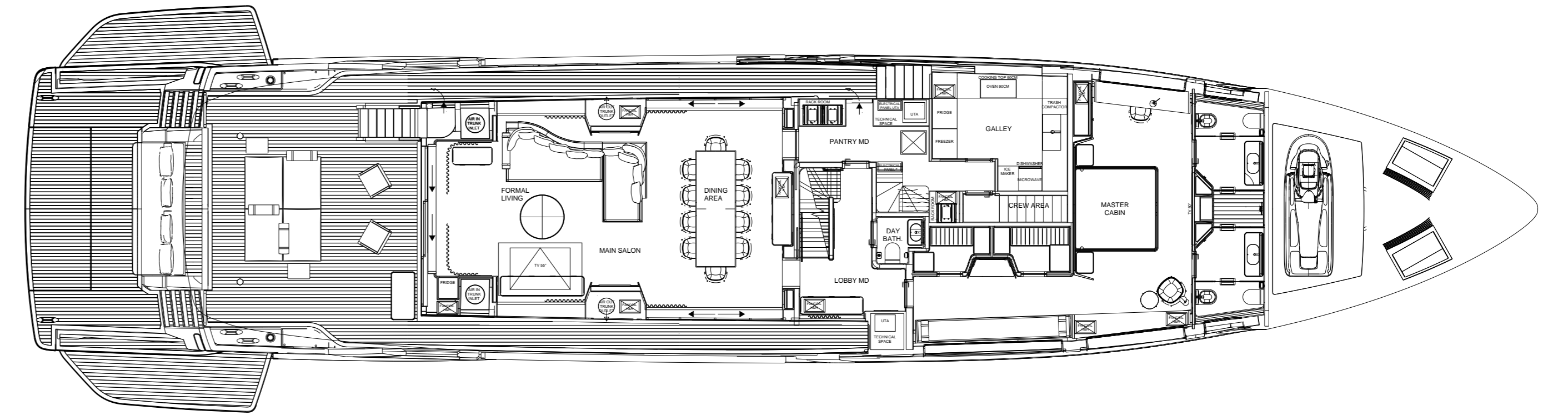

Upper deck

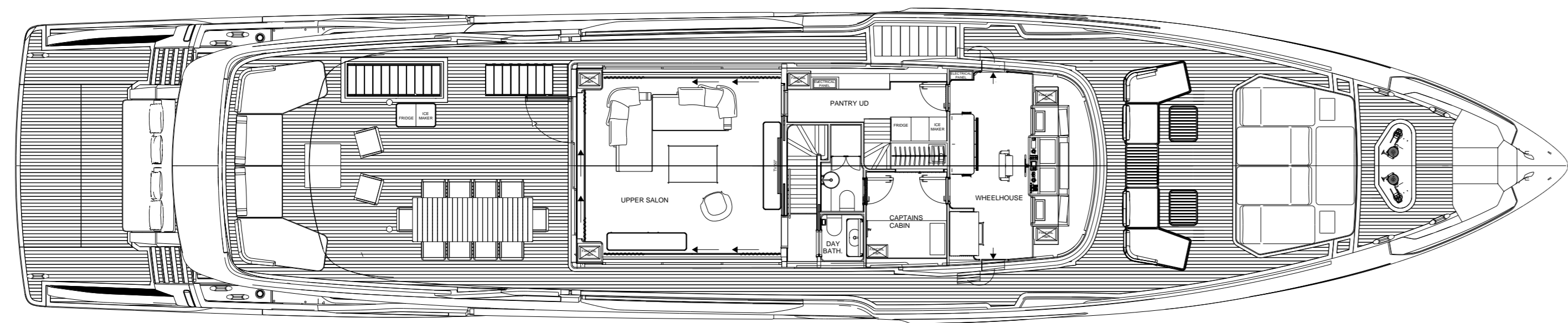

Lower deck

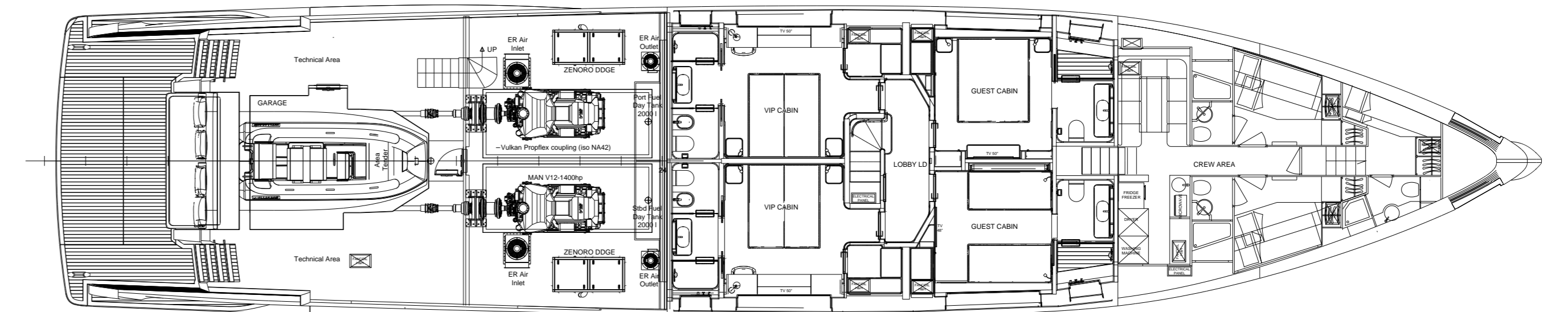

## *Leading the Future*



### **Creiamo grandezza**

Come Gruppo leader della nautica di lusso, è questo il nostro impegno primario, l'ispirazione che ci guida, individualmente e collettivamente. È il valore che trasmettiamo ai nostri dipendenti, ai nostri brand, agli armatori.

### **Miglioriamo gli standard della nautica**

Incoraggiamo i nostri professionisti a utilizzare know-how ed esperienza per rendere la nautica di lusso un polo di attrazione e un motore di sviluppo economico e tecnologico.

### **Crediamo nell'innovazione**

Ferretti Group raggiunge l'eccellenza grazie alla costante innovazione e all'adozione di tecnologie avanzate. È così che otteniamo performance eccellenti e garantiamo sicurezza in mare, offrendo agli armatori esperienze senza eguali.

### **Creiamo valore**

Supportiamo con risorse ed energie lo sviluppo a lungo termine dei nostri brand, rafforzando ulteriormente la loro capacità di creare valore. Questo ha assicurato negli anni un successo straordinario, consentendoci di diventare leader indiscusso nel settore della nautica di lusso.

### **Siamo vicini ed efficaci**

Ferretti Group ha costruito nel tempo una rete internazionale di dealer e assistenza, così da soddisfare ogni necessità e desiderio degli armatori in ogni parte del mondo. La vicinanza al cliente è uno degli ingredienti del nostro successo duraturo.

### **Consideriamo l'impatto ambientale**

Consapevole della necessità di considerare l'impatto ambientale e sociale dei propri prodotti e processi, Ferretti Group pubblica annualmente un Bilancio di Sostenibilità. Il documento illustra i principali effetti ambientali derivanti dalle attività del Gruppo e delinea le iniziative in atto per uno sviluppo sostenibile.

### *Creating Greatness*

*This is our commitment as a luxury yachting group. This is the spirit that drives us, individually and collectively. This is the value we bring for our employees, our brands, our clients and society as a whole.*

### *Empowering Expertise*

*We continually spur each of our brands to go further. We leverage their special know-how, artisanal accomplishment and technological expertise to stay at the cutting edge of the nautical world.*

### *Striving for Innovation*

*Ferretti Group delivers excellence through constant innovation and pioneering technology. This is how we achieve formidable performance and safety at sea, offering clients authentic experiences to satisfy their desires for affirmation and self-expression.*

### *Creating Value*

*We focus our energy and resources on supporting our brands in their long-term development, further boosting their ability to create value. This has earned us extraordinary success over the years, helping the group become a pre-eminent player in today's yachting sector.*

### *Going Global*

*Ferretti Group always endeavours to be close to the market and to our customers, doing whatever it takes to deliver exceptional performance. We have built up an agile, resourceful international dealer network, supported by high-end marketing initiatives to enhance our brands' worldwide visibility and profile.*

### *Softening our impact on the environment*

*Ever aware of the need to consider the environmental and social side-effects of our products and processes, Ferretti Group publishes a Sustainability Report every year. This document maps the main impacts of our activities and outlines the initiatives in place towards more sustainable development.*

## LEGAL NOTICE

1. This brochure does not constitute an offer by the shipyard to any person under any circumstances whatsoever, nor may it be incorporated into any contract.
2. All the information in this brochure, including without limitation all technical and performance data, illustrations and drawings, has no contractual effect. That information refers to European standard models of motor yachts built by the shipyard and is accurate at the brochure's date of issue. The only valid technical description or reference content for an individual motor yacht is the exact specification stated at the time of purchase. Therefore, the only information that is binding on the seller is that contained in the sale agreement and associated manual. This brochure is based on information available at the date of issue. Notwithstanding Ferretti Group's best efforts to ensure accuracy, the information in this brochure may not cover all details or subsequent changes, nor does it claim to accurately foresee or detail all possible scenarios. Displays, photos, diagrams, designs or examples in this brochure are reproduced solely and exclusively to highlight the information contained. Each yacht is different, so the shipyard declines any and all liability for any use thereof on the basis of the information in this brochure.
3. The brochure and its contents must not be copied or reproduced in their entirety or in part.
4. Sale of this brochure is not permitted.

### Technical drawings & renderings:

Ferretti Group Engineering  
Filippo Salvetti  
Antonio Citterio Patricia Viel

### Concept and art direction:

Armando Testa

### FERRETTI GROUP SUPERYACHT YARD – CUSTOM LINE

Via Enrico Mattei, 26 · 60125 – Ancona, Italy

[customline-yacht.com](http://customline-yacht.com)

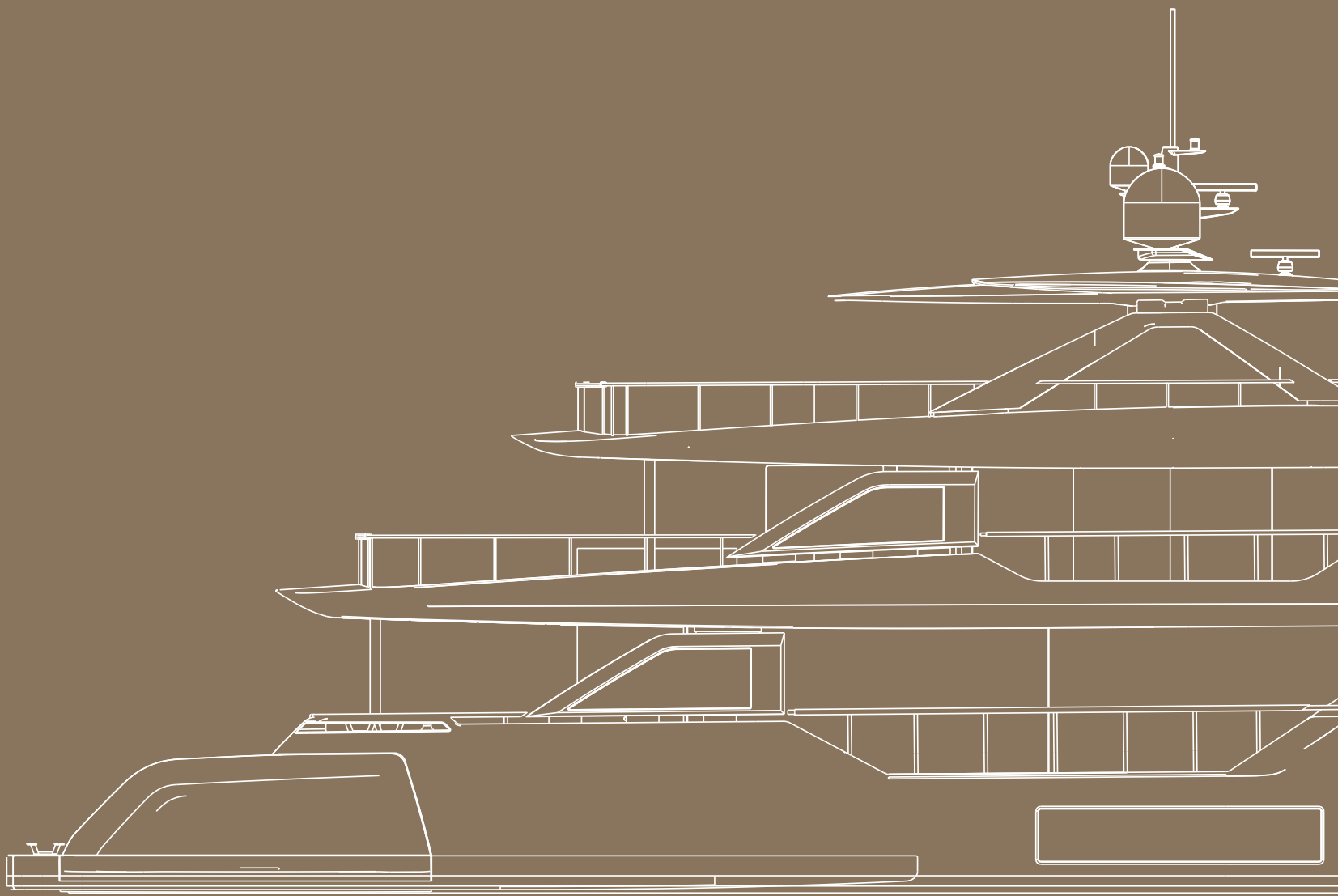

## CUSTOM LINE

---

BEYOND THE LINE